

# ES/1 Boxed Timed Strobe Unit (SP40)

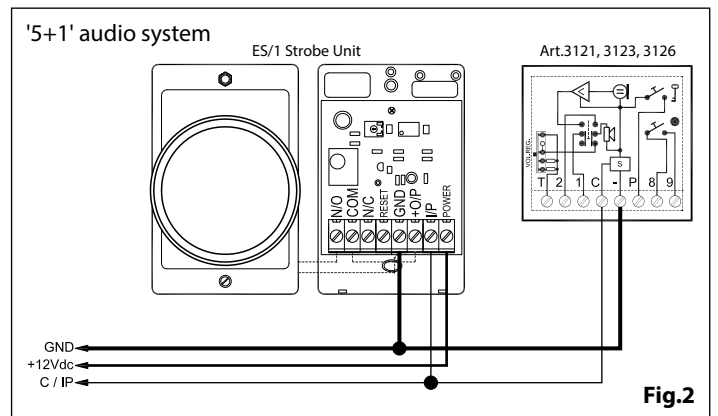
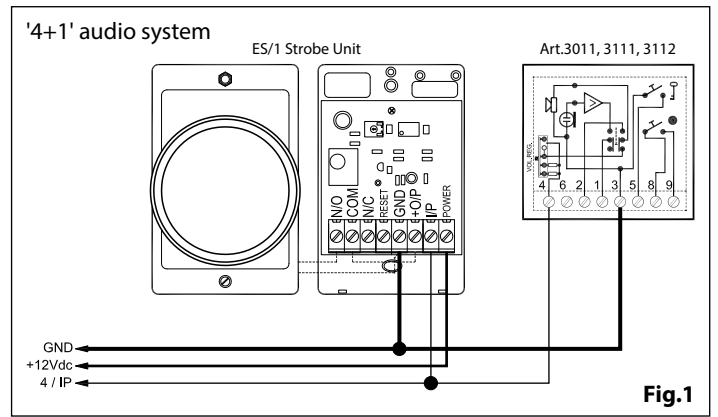
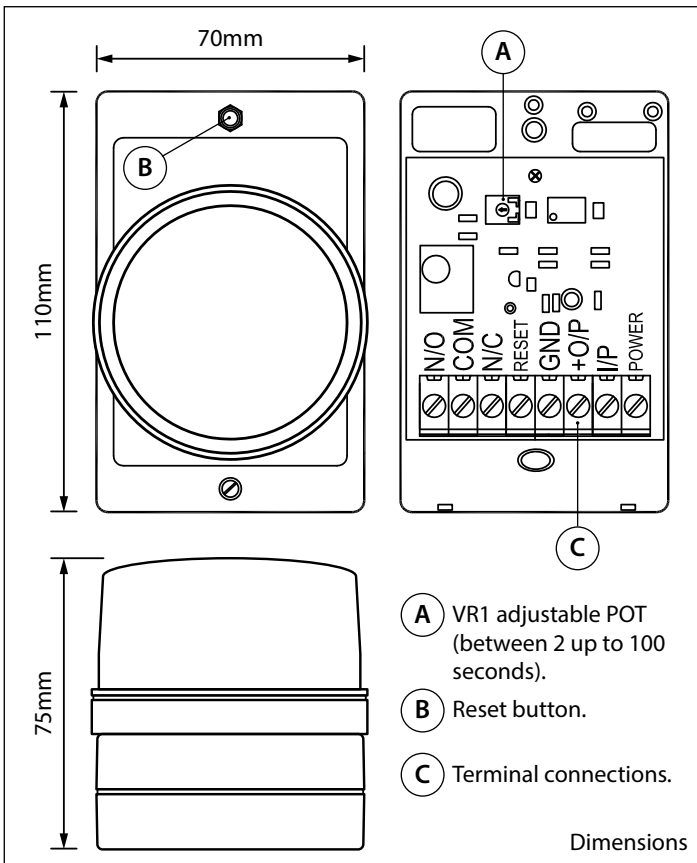

## ES/1 BOXED TIMED STROBE UNIT (SP40)

The ES/1 is a timed strobe unit developed for the hard of hearing or can be used in noisy environments. The strobe will flash when a call is received on an intercom system and will continue to flash for an adjustable time period or until the reset button is pressed. It requires 12Vac or dc power input and the time period can be set between 2 up to 100 seconds using the VR1 adjustable POT. **Fig.1** shows connections for a '4+1' audio system and **Fig.2** shows connections for a '5+1' audio system.

## TECHNICAL SPECIFICATION

<b>Working Voltage:</b>	12Vac or dc
<b>Input Trigger:</b>	+positive ac or dc
<b>Current (standby):</b>	6.6mA
<b>Current (during call):</b>	160 - 175mA (180mA max.)
<b>Working Temperature:</b>	-10 to +50°C

## TERMINAL CONNECTIONS

Terminal	Function
Power	12Vac or dc power input
I/P	+positive trigger (ac or dc)
+O/P	12Vdc output
GND	0V (ground)
Reset	Switched 0V reset
NC	Normally closed relat connection
CO	Common relay connection
NO	Normally open relay connection

## CUSTOMER SUPPORT

**UK Customers:**  
**VIDEX SECURITY LTD**  
 www.videxuk.com - tech@videxuk.com  
 Tech Line: 0191 224 3174  
 Fax: 0191 224 1559

**CE** The product is CE marked demonstrating its conformity and is for distribution within all member states of the EU with no restrictions. This product follows the provisions of the European Directives 2014/30/EU (EMC); 2014/35/EU (LVD); 2011/65/EU (RoHS): CE marking 93/68/EEC.